

# 3AT1021

Starter kit for **3SM1004** SoM

**elettronica GF**

## FEATURES

- Support all 3SM1004 series SOM
- Complete and flexible solution
- Huge availability of peripherals
- Designed to speed up and simplify 3SM1004 based product development

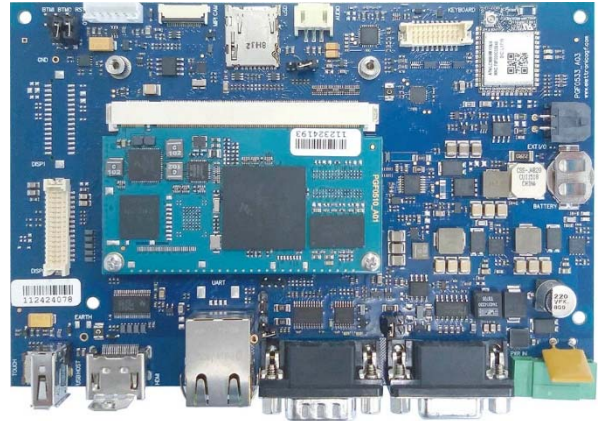

### CPU

- NXP i.MX6 Quad/Dual/DualLite/Solo ARM® Cortex®-A9 CPU
- CPU core 1/2/4
- CPU Frequency 800/1000/1200 MHz

### MEMORY

- Up to 4 GB DDR3 up to 1066MHz (32/64 bit)

### STORAGE / BOOT

- Up to 64 GB eMMC
- $\mu$ SD slot

### Display and touch

- Support up to two display 4XGA (2048x1536)
- Four display ports available HDMI, 2LVDS, Parallel
- Support for PCT projective capacitive touch screen
- Support for 4-wire resistive touch screen

### PERIPHERALS

- USB 2.0 Host
- USB 2.0 OTG
- Ethernet 1Gbps
- FLEXCAN BUS Interfaces
- RS232 (TX,RX,RTS,CTS)
- RS485 full duplex
- Serial Port SW selectable between RS232 or RS485 Full
- Up to 2 Digital I/O
- Keyboard 5X5
- Up to 2 SPI Interfaces
- Up to 2 I2C BUS Interfaces
- GPIOs available
- Audio output
- BLE 5.0
- WiFi 2.4 GHz IEEE 802.11 b/g/n
- 1 x MIPI camera connector (See Camera board 3AT1019)
- Buzzer
- Temp Sensor
- RTC

### SYSTEM

- Single +12-24 VDC  $\pm$ 10% power supply

### OPERATING SYSTEMS

- Linux
- Android



<sup>1</sup> Please note that all function may not be available simultaneously, due to pin muxing limitation of SOM connector restrictions. Function availability depends also on the installed processor. For more details refer to processor datasheet

## BOARD FUNCTION

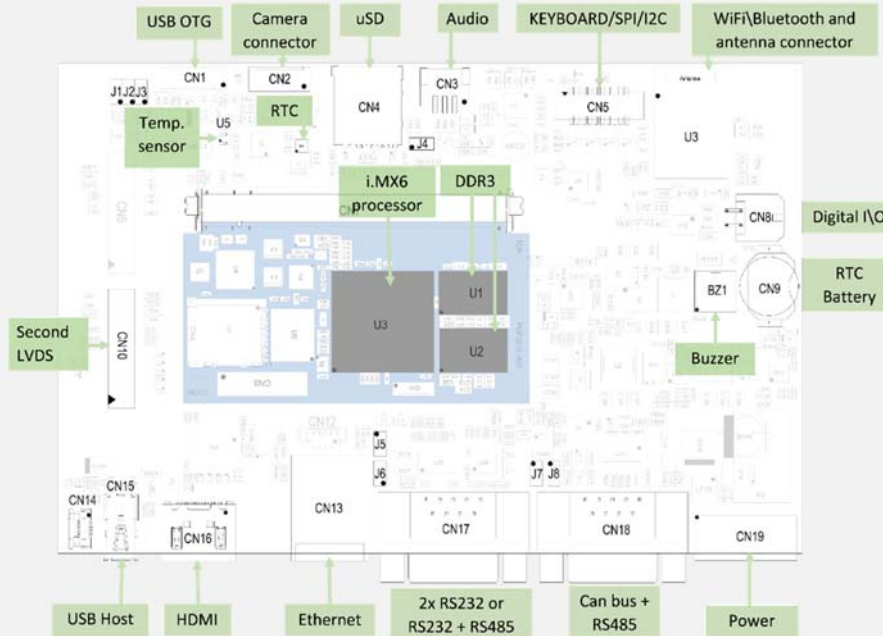

## DIMENSIONS

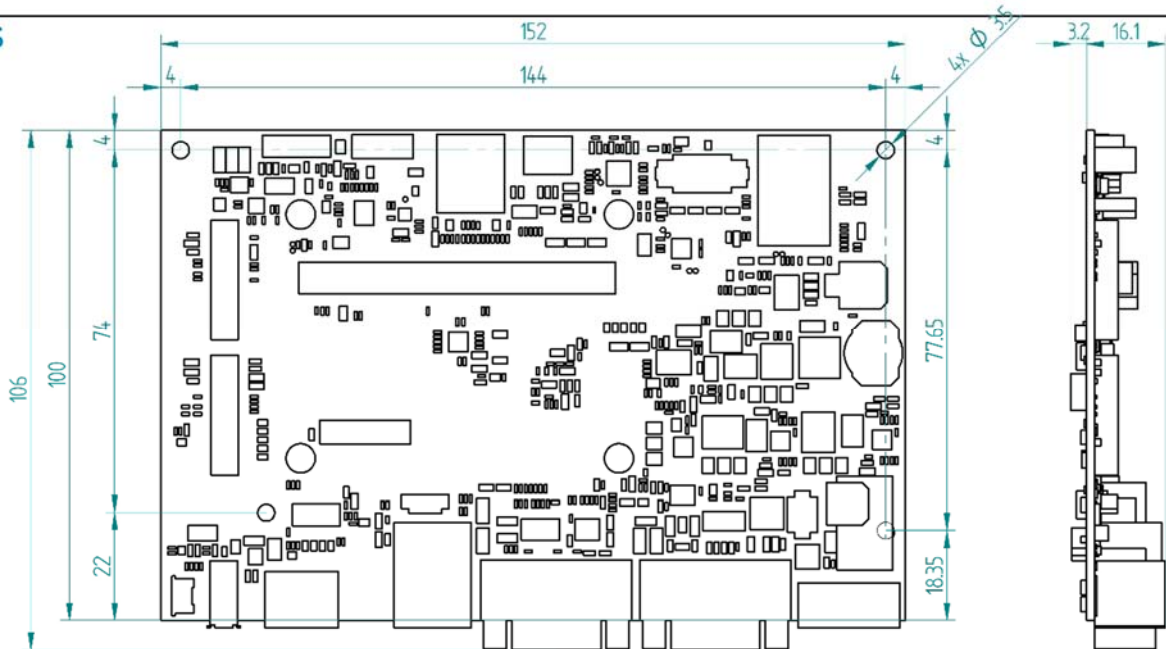

All dimensions are in mm

## Standard ordering code

Ordering Code	Descriptions
3AT1021_A02	Starter kit 7" display OS Linux
3AT1021_B02	Starter kit 10.1" display OS Linux
3AT1021_C02	Starter kit 10.1" display OS Android

## Starter kit components list

- 3HI1001 D 2 B 4 C Q + Secondary LVDS (for 3AT1021\_A02)
- 3HI1005 D 2 B 4 C Q + Secondary LVDS (for 3AT1021\_B02 and 3AT1021\_C02)
- Camera Module based on OV5640 5MP code 3AT1019
- USB OTG cable code BCA3005
- USB key 8GB
- microSD 8GB
- Power supply 12V 2A code JKT1050
- Serial debug cable code JCA3101

Any third-party logos, service marks and trademarks included in this leaflet are property of their respective owners. Elettronica GF S.r.l. reserves the right to make changes, without notice, to the content of this document. No warranty of accuracy is given concerning the contents of the information contained in this publication

**Elettronica GF S.r.l.** Via Ca' Bianca, 10 - 48018 - Faenza (RA) - Italy  
 Tel. (+39) 0546 622245 Fax (+39) 0546 622301  
 Web: [www.elettronicagf.com](http://www.elettronicagf.com) Mail: [sales@elettronicagf.it](mailto:sales@elettronicagf.it)  
 3AT1021-FL-EN\_A02